

TECHNICAL SPECIFICATION		ACCOMODATION / FACILITIES	
VESSEL NAME	JOPETWIL 300	NUMBER OF BED	270
CLASSIFICATION	DNV-GL	MESS ROOM	3
CLASS NOTATION	SELF-ELEVATING ACCOMMODATION BARGE	MEETING ROOM	2
IMO No.	9720093	RECREATION ROOM	3
CALL SIGN	A6E2173	OFFICE	7
OFFICIAL No.	7562	HELI LOUNGE	5
BUILDER	SHISUNG CO-SOUTH KOREA	HOSPITAL	1
YEAR OF BUILT	2013	PRAYER ROOM	1
FLAG/PORT of REGISTRY	UAE / ABU DHABI	GYM	1
OWNER	JOPETWIL INDUSTRIAL COMPANY LLC		
PRINCIPAL PARTICULARS		MACHINERY	
LENGTH OVERALL	88.78M	MAIN ENGINE	3 Nos. 940 KW
LENGTH B.P	58.0 M	EMERGENCY ENGINE	1 Nos. 350 KW
BREATH MOULDED	32.0 M	WATER MAKER	2 Nos. 50 m ³ /Day
DEPTH MOULDED	5.0 M	SEWAGE TREATMENT PLANT	59 m ³ /Day, 260 PERSONS
DESIGNED DRAFT	3.512 M	BALLAST PUMPS	2 Nos. 400 m ³ /hr
GRT	4568T	FIRE PUMPS	2 Nos. 190 m ³ /hr
NRT	1370T	RAW WATER PUMP	2 Nos. 455 m ³ /hr
DISPLACEMENT	6453T	JACKING SYSTEM	
NO OF LEGS	4	MODEL TYPE	ELECTRO HYDRAULIC DRIVEN POSITIVE
LEG LENGTH	70 M	MAKE / MODEL	ENGAGED SYSTEM PIN & HOLE
DECK SPACE	500	STORM HOLDING CAPACITY	SAMDO CMC / SJS -1050
TANK CAPACITY		JACKING CAPACITY	4800 TON
FUEL OIL	166.20 MT	LOWERING LEG	15 M / HR
FRESH WATER	373.38 MT	RAISING HULL	15 M / HR
BALLAST	1881.07 MT	SAFETY EQUIPMENT	
SEWAGE STORAGE TANK	55.29 MT	FRC	01 NOS FOR 6 PERSON
ENDURANCE	21 DAYS	LIFE JACKET	350
DECK CRANES		LIFE BOAT	2 X 100 PERSON PORT @ STBD 1 X 120 PERSON PORT @ STBD
MAIN CRANE MAKER	FAVELLE FAVCO CRANE MALAYSIA	LIFE RAFT	16 X 25 PERSON
TYPE	PC 300 OFFSHORE PEDESTAL CRANE	EEBD	300
CAPACITY	280 TONES AT 20 M RADIUS	FIXED GAS DETECTION SYSTEM	12 CHANEL H2S AND LEL
MAX BOOM LENGTH	62 M	FIXED FIRE DETECTION SYSTEM	ALL LEVELS
AUXILIARY CRANE MAKER	SEATRAX	HELIDECK	
TYPE	DIESEL DRIVEN	TYPE	S92 / S61 N
CAPACITY	50 TONS	MAXIMUM TAKE-OFF WEIGHT	12.0 t
MAX BOOM LENGTH	24.38 M	MATERIAL	ALUMINUM PANCAKE & STEEL SUPPORT

MOORING SYSTEM		NAVIGATION EQUIPMENT	
MOORING WINCHES	4 Nos.	GMDSS WALKIE TALKIE	03 SAMYUNG SAR 09
MAXIMUM WINCH PULL	25 MT X 11m / MIN.	VHF DSC	02 SAILOR
WINCH TYPE	ELECTRO HYDRAULIC WITH CENTRAL CONTROL	PORTABLE VHF RADIO	10 ENTEL
WIRE	46 mm dia, 28.2 MT MBL 145 MT	EPIRB	MCMURDO MS
	400m on each drum	SART	MCMURDO MS (8 Pcs.)
BOLLARD	8 Nos. SWL 28.2 MT	MF/HF	SAMYUNG-SAR 9
CLOSED CHOCK	2 Nos. 400 X 250, 1 Nos. 500 X 250, SWL 28.2 MT	NAVTEX RECEIVER	MCMURDO MS
GUIDE SHEAVE	SC480 MATERIAL FOR 46 MM WIRE	ECHO SOUNDER	JMC - F 3660 W
UNIVERSAL FAIRLEAD	SC480 MATERIAL FOR 46 MM WIRE	RADAR	KODEN
TOWING AND ANCHORING		MAGNETIC COMPASS	PLASTIMO OFFSHORE
		AIS	MCMURDO MS
DELTA PLATE	2 Nos. 50 MT	LRIT	POLESTAR UK
RECOVERY WINCH	3 MT (Installed in Forward top deck)	MARINE SATELITE	ALL ROOMS
OPERATIONAL CONDITION		INTERNET FACILITIES	ALL ROOMS
		SURVIVAL CONDITION	
WATER DEPTH	40 M	WATER DEPTH	40 M
WAVE HEIGHT	1.5 M	WAVE HEIGHT	8.0 M
WAVE PERIOD	8 s	WAVE PERIOD	6 s
CURRENT VELOCITY	1.5 m/s	CURRENT VELOCITY	1.5 m/s
WIND VELOCITY	25.8 m/s	WIND VELOCITY	51.5 m/s
LEG PENETRATION MAX	8 M	LEG PENETRATION MAX	8 M
AIR GAP MAX	6 M	AIR GAP MAX	6 M

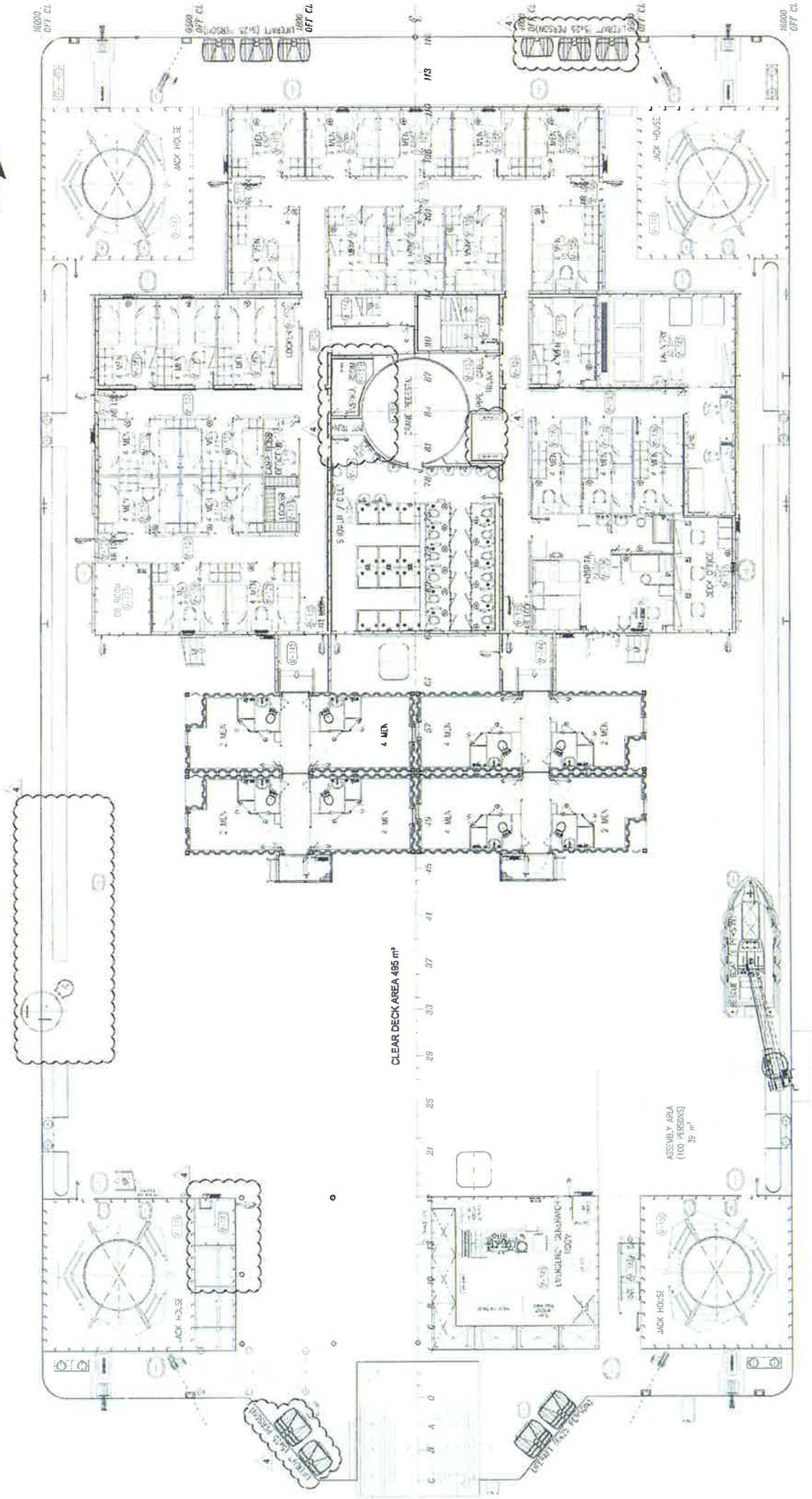

MAIN DECK
 ELEV. 5000 ABL
 4 MEN x 23 = 92
 MODULAR ACCOMM.: 4 Nos. (2 MEN x 4 + 4 MEN x 4 = 24)

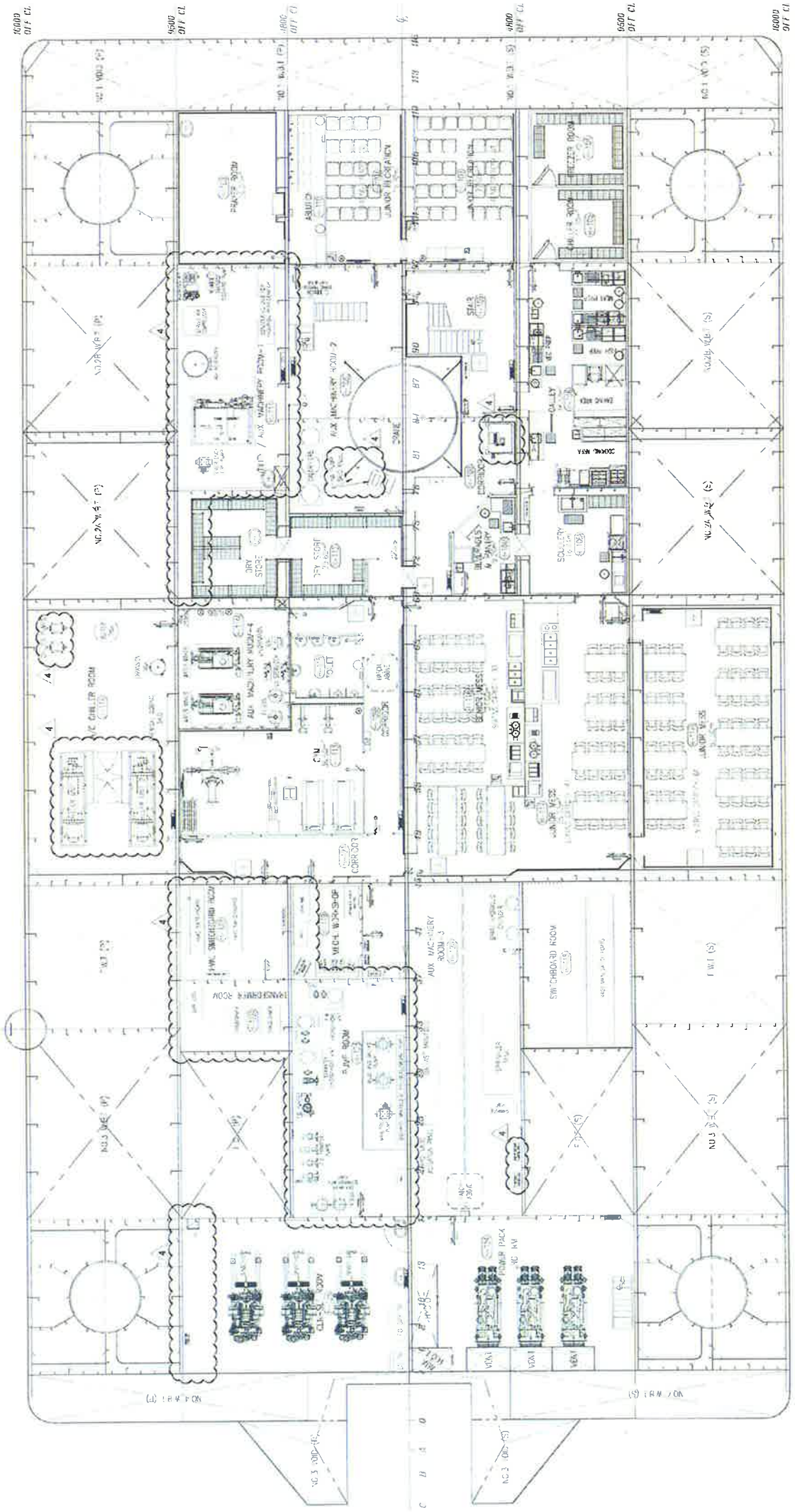

16000
DIT CL

9500
DIT CL

1800
DIT CL

6

4800
DIT CL

6500
DIT CL

16000
DIT CL

HOLD PLAN
ELEV 1250 ABL